

# UNIVERSAL LIGHTPROBE™ INSTALLATION ACCESSORIES

## MOUNTING METHODS:

The simplest method of installing the Universal LightProbe sensors is to use a single clamp (P/N: ULP-CP) for the sensor with a single #10-ANSI screw for one-hole fixing. Alternately, customers have also used “zip ties” as shown below.

**Sensor Mounting Clamp**



**Sensor Clamp Dimensions**

Top View

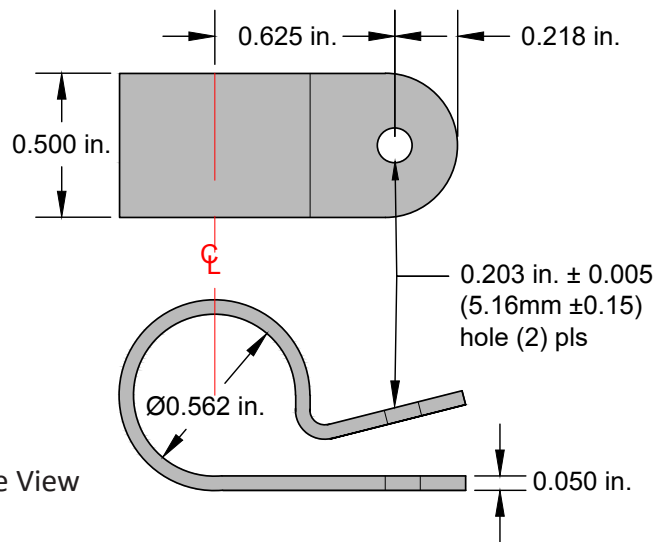

Side View  
NTS

**“Zip Tie” Mounting**

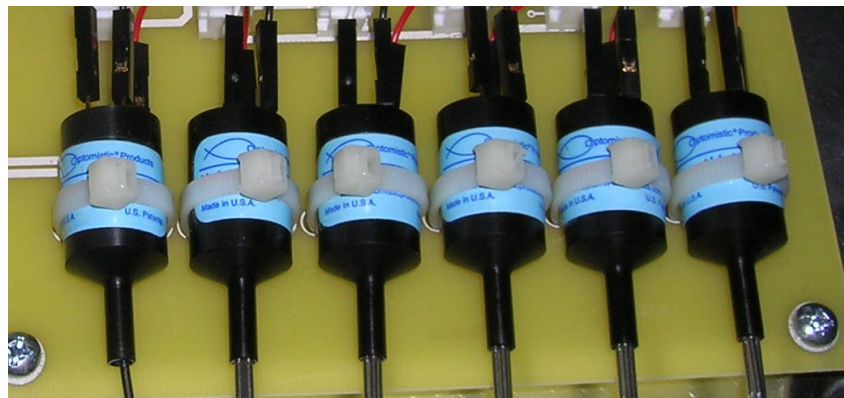

# UNIVERSAL LIGHTPROBE™ INSTALLATION ACCESSORIES

## MOUNTING METHODS - Continued:

Individual plastic clamps are available for all styles of our fiber-optic probe (P/N LCP-XX), which can be used to secure the stainless-steel tip to the probe-plate, allowing the height of the probes above the LEDs to be adjusted. The clamps can also be used to set and secure the contacting-tipped probes with the correct pre-travel.

### Fiber-Optic Probe Clamp

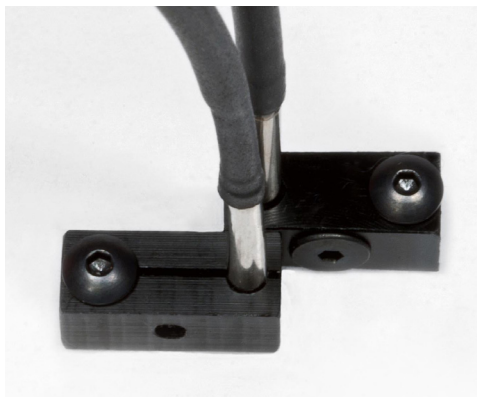

### Probe Clamp Dimensions

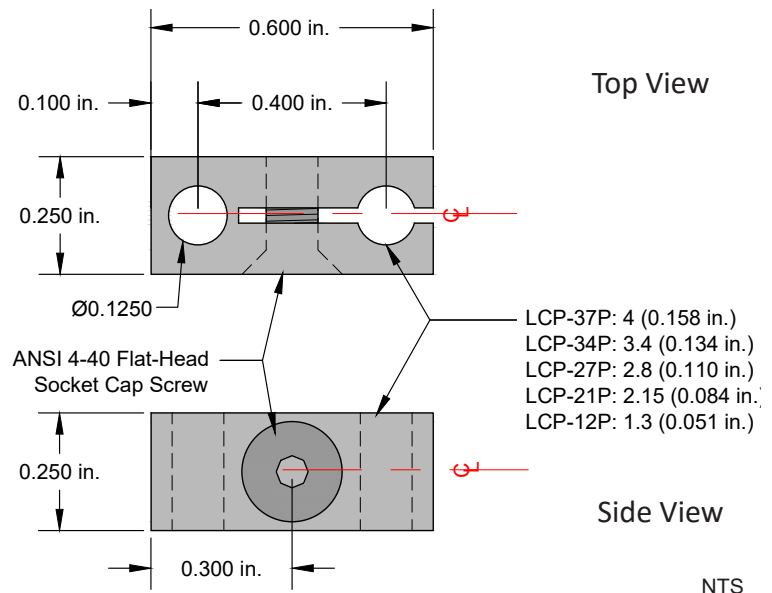

Fiber-Optic Probe Clamp



Probe Clamp Mounted On A Probe Plate

## UNIVERSAL LIGHTPROBE™ INSTALLATION ACCESSORIES

### MOUNTING METHODS - Continued:

#### Fiber-Optic Socket Clamp

For our small-aperture fiber-optic-probes, including the popular “Trident” fiber-optic probe, we also offer Socket “Clamps” (P/N LCP-S12) to secure the stainless-steel tips in the probe plate.

Romex eq. SPR-2Y

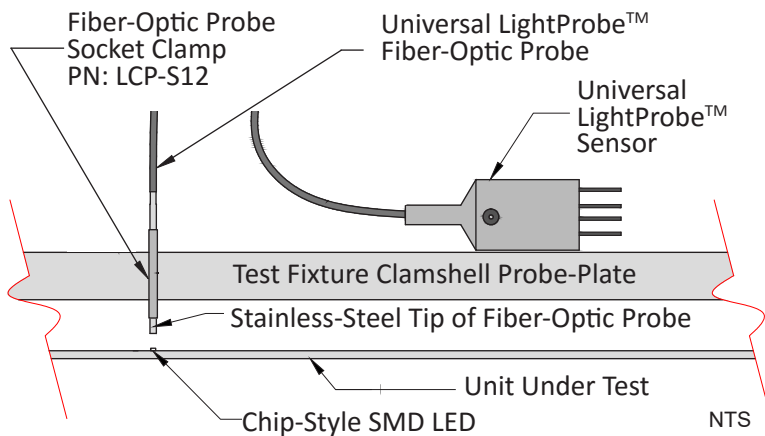
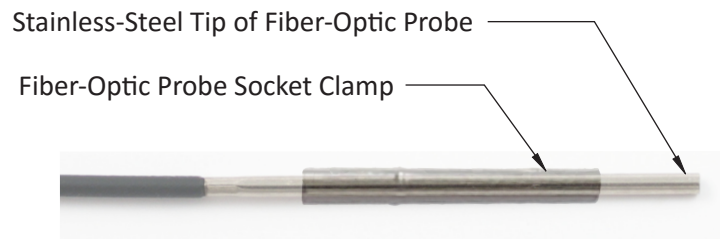
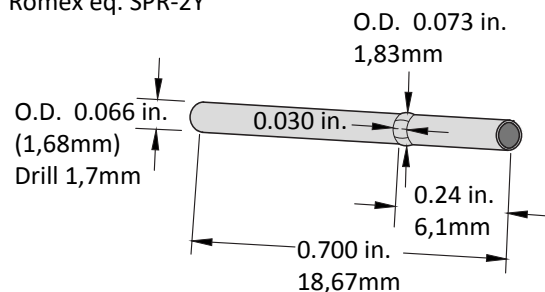

1. Accurately align probe-plate socket holes with the LEDs under test.
2. Using No. 51 drill (0.067-0.068 in. dia.), drill holes centered and on-axis with the LED under test.
3. Use socket insertion tool to insert the socket to the desired depth into the probe plate, but sufficient to grip the annular collar of the socket.
4. Set the air-gap between the fiber-optic probe tip and the LED under test between 1mm and 3mm (1mm for closely spaced LEDs)

#### Fiber-Optic Probe Socket Clamp Insertion Tool

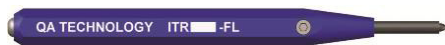

Used to install Socket Clamps in the probe plate.  
P/N ITR100-FL

#### Fiber-Optic Probe Socket Clamp Extraction Tool



Used to extract Socket Clamps from the probe plate.  
P/N ETR100-OP